



MDR B2

FLXMOD

DC motor driver module

Description

FLXMOD™ system DC motors driver module. This unit, designed for mounting on a standard DIN rail and housed in a compact plastic case, is able to drive two DC-brush motors; speed and position control are possible whenever the motors are equipped with single or twin Hall sensors. Proprietary FLXIO™ bus ensure reliable real-time communication with the CPU.



Smitec S.p.A.

Viale Vittorio Veneto, 4 - 24016 San Pellegrino Terme (BG) ITALY
Tel. +39 0345 40.800 - Fax: +39 0345 40.809 - www.smitec.it

Head office:

Via Carlo Ceresa, 10 - 24015 San Giovanni Bianco (BG) ITALY
C.F. e P. IVA IT03790400166

Technical data	
Housing material	Polypropylene
Degree of protection	IP20
Motor outputs	2, for DC brush motors (24V _{DC})
Outputs characteristics	MOSFET H-bridge, PWM controlled 4 A each @ 312Hz, 8 A max @ 45°C total
Overcurrent and overload protection	Programmable
Feedback inputs	For single or twin Hall sensor, open-collector type. The inputs are 24V tolerant
Feedback sensors power supply	5V ± 10%, 100mA max.
Interface	Proprietary FLXIO™
Bus address setting	By rotary switch
Electrical specifications	Power supplies: I/O supply: 24V _{DC} / 8A max. Logic supply: 24V _{DC} and 5V _{DC} from backplane
Environmental specifications	Operating temperature: from +5°C to +45°C Storage temperature: from -25°C to +85°C Relative humidity: from 10% to 95% (non condensing)
Certifications	CE, cULus

Dimensions

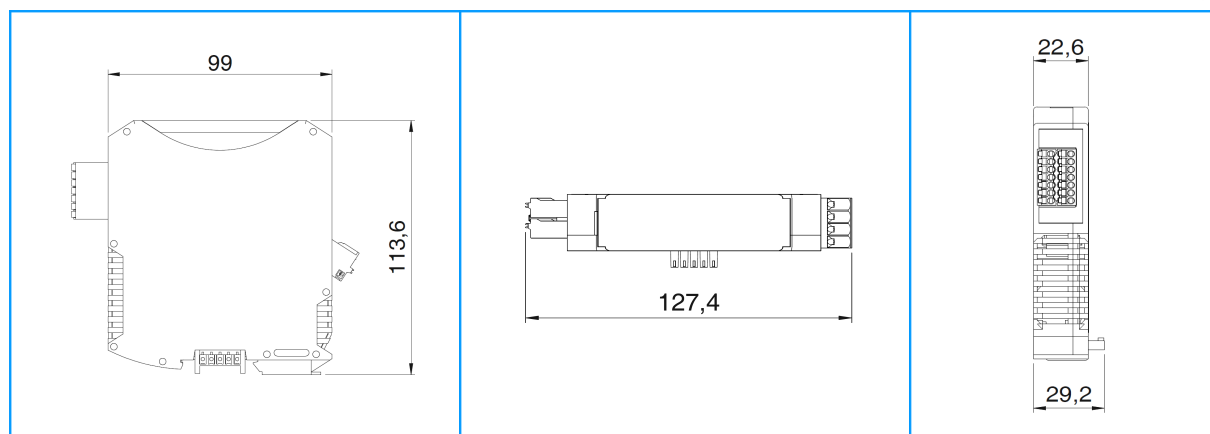

Data here mentioned are subject to changes without any notice.